

Tequesta Gardens Property Enhancement Recommendation:

Recreation Area Fencing Replacement



Fencing Replacement - Identified as a #1 Priority by Residents*

The proposed fencing project is to replace the existing chain link fencing around the recreation area with 4-foot-high black aluminum post panel fence

Proposed Fence Replacement
Area:
Perimeter Around Recreation
Area

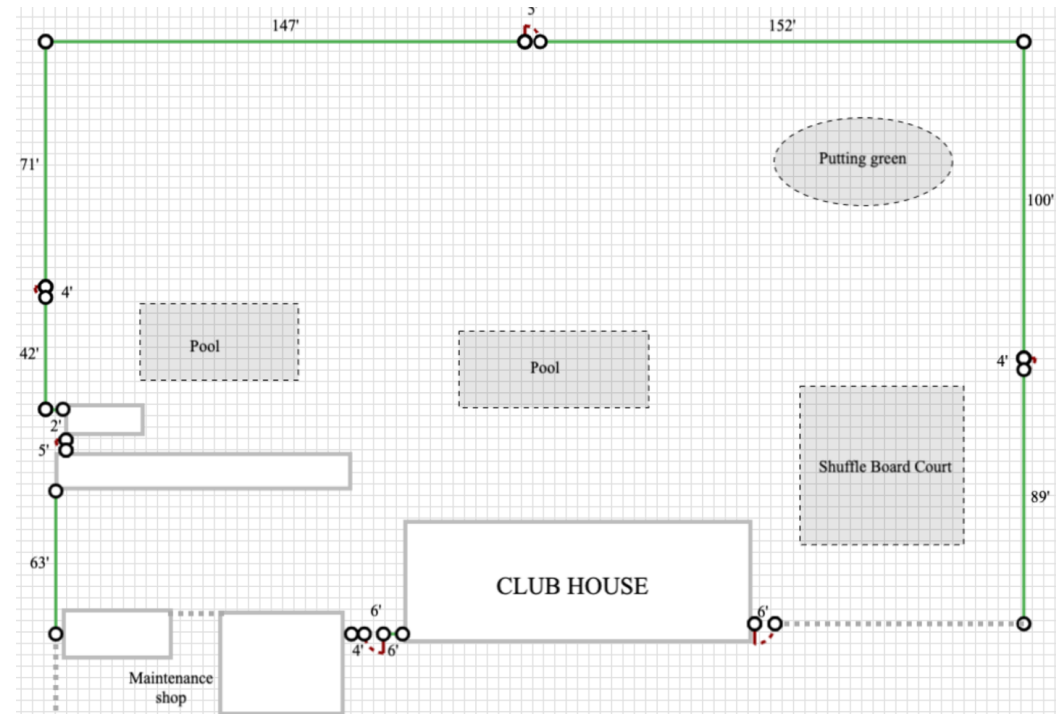

* At a meeting of the Property Enhancement Committee held on 4/11/22 with residents in the Club House and on Zoom

Replace existing chain link fence with post panel style

RECOMMENDED -

Black Heritage Style Fencing:

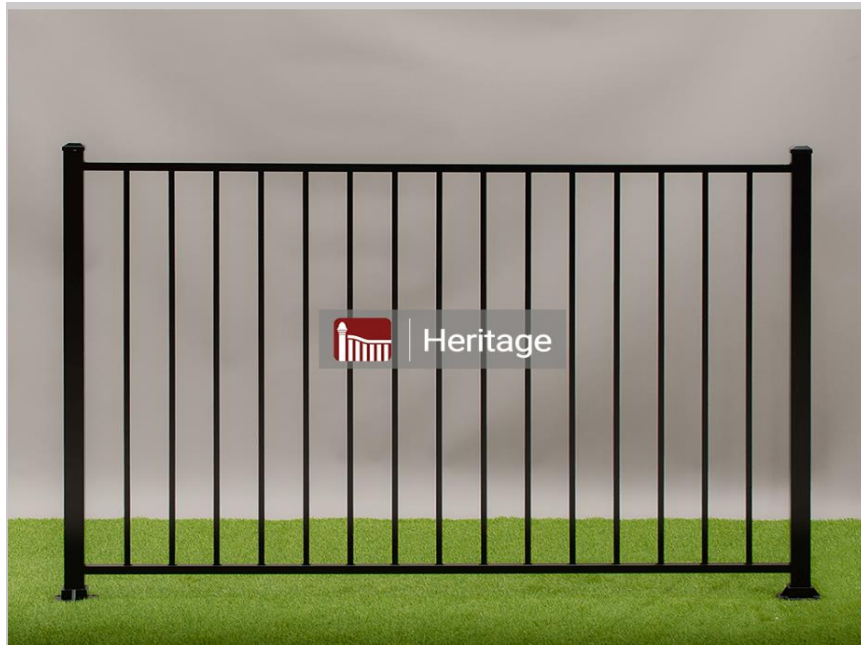

ALTERNATIVE -

Chain Link Fence:

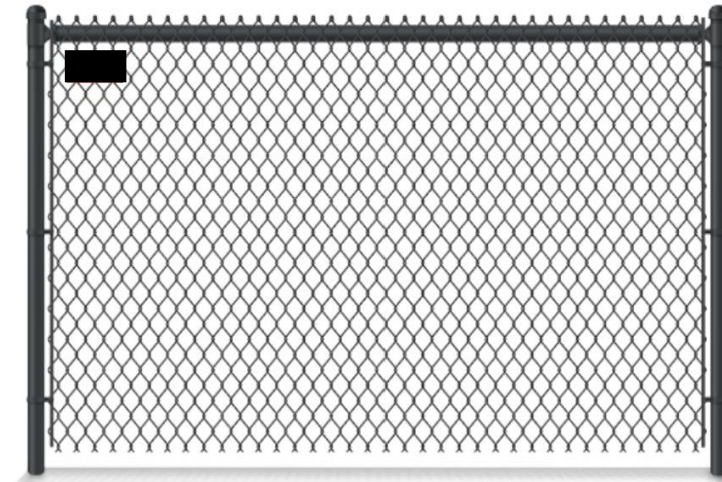

Sample Fencing Installed Pool Side at a Newly Constructed 55+ Community



Sample Fencing Installed at a Newly Constructed 55+ Community Club House



Reasons stated by residents to support this project were:

- The existing chain link fence is in disrepair. It is leaning over in several locations, is rusty, and does not represent the quality of our community.
- The club house and pool area are at the center of our community and are frequent gathering place for residents. We want these areas to look nice.
- The club house and pool area are frequently visited by family, friends and potential buyers.
- An improvement of the fencing improves the overall appearance of the community.
- Property value is important to our residents. Making these common area improvements will increase property value according to a local licensed real estate agent.
- Existing chain link fence is a safety concern.
- Using a dark colored material with vertical lines allows the fence to visually blend in with the beautiful landscaping surrounding this area.
- We specifically are not recommending white because of the sprinkler water discoloration.
- The open nature of the posts will allow for good air circulation and also maintain an open feel for the area as you can easily see through it.
- Don't have to remove shrubs for installation.
- Residents would tangibly see how their money is being spent to improve our community while we continue to fund general maintenance work.
- Overall, this project would help to modernize our community.

Cost Comparison

RECOMMENDED -

Black Heritage Style Fencing:



- \$35,000 est
 - Approx \$140/unit or \$12/month for a year
 - \$18,000 more than chain link;
\$72.60/unit or \$6.05/month for a year
more than the alternative
- Includes gate replacement to match
- Lifetime Warranty
- Expenditure requires a vote for approval from the community

ALTERNATIVE -

Chain Link Fence:

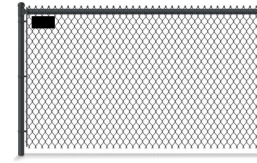

- \$17,000 est
 - \$69/unit or \$5.71/month for a year
- Reuse existing gates
- 10-15 year Warranty
- Expenditure can be authorized by the Board of Directors

Please submit questions or comments via email to TGFence22@gmail.com or drop them in the TG Office mail slot.

Responses can be provided if you give us your email address.